



WOKINGHAM BOROUGH COUNCIL

A Meeting of an **INDIVIDUAL EXECUTIVE MEMBER DECISION** will be held in First Floor 12 - Civic Offices, Shute End, Wokingham RG40 1BN on **THURSDAY 27 JULY 2023 AT 1.00 PM**

Susan Parsonage
Chief Executive
Published on 19 July 2023

Note: Non-Committee Members and members of the public are welcome to attend the meeting or participate in the meeting virtually, in line with the Council's Constitution. If you wish to participate either in person or virtually via Microsoft Teams please contact Democratic Services. The meeting can also be watched live using the following link:
<https://youtube.com/live/k4RpEfHlpnE?feature=share>

Please note that other people may film, record, tweet or blog from this meeting. The use of these images or recordings is not under the Council's control.



WOKINGHAM BOROUGH COUNCIL

Our Vision

A great place to live, learn, work and grow and a great place to do business

Enriching Lives

- Champion outstanding education and enable our children and young people to achieve their full potential, regardless of their background.
- Support our residents to lead happy, healthy lives and provide access to good leisure facilities to complement an active lifestyle.
- Engage and involve our communities through arts and culture and create a sense of identity which people feel part of.
- Support growth in our local economy and help to build business.

Safe, Strong, Communities

- Protect and safeguard our children, young and vulnerable people.
- Offer quality care and support, at the right time, to prevent the need for long term care.
- Nurture communities and help them to thrive.
- Ensure our borough and communities remain safe for all.

A Clean and Green Borough

- Do all we can to become carbon neutral and sustainable for the future.
- Protect our borough, keep it clean and enhance our green areas.
- Reduce our waste, improve biodiversity and increase recycling.
- Connect our parks and open spaces with green cycleways.

Right Homes, Right Places

- Offer quality, affordable, sustainable homes fit for the future.
- Build our fair share of housing with the right infrastructure to support and enable our borough to grow.
- Protect our unique places and preserve our natural environment.
- Help with your housing needs and support people to live independently in their own homes.

Keeping the Borough Moving

- Maintain and improve our roads, footpaths and cycleways.
- Tackle traffic congestion, minimise delays and disruptions.
- Enable safe and sustainable travel around the borough with good transport infrastructure.
- Promote healthy alternative travel options and support our partners to offer affordable, accessible public transport with good network links.

Changing the Way We Work for You

- Be relentlessly customer focussed.
- Work with our partners to provide efficient, effective, joined up services which are focussed around you.
- Communicate better with you, owning issues, updating on progress and responding appropriately as well as promoting what is happening in our Borough.
- Drive innovative digital ways of working that will connect our communities, businesses and customers to our services in a way that suits their needs.

For consideration by

Paul Fishwick, Executive Member for Active Travel, Transport and Highways

Officers Present

Matt Gould, Lead Specialist, Highways and Transport

Callum Wernham, Democratic & Electoral Services Specialist

IMD NO.	WARD	SUBJECT
IMD 2023/14	Emmbrook; Norreys; Shinfield South; Wescott	MOVING TRAFFIC ORDERS FOR MTE SITES 5 - 24

CONTACT OFFICER

Callum Wernham

Tel

Email

Postal Address

Democratic & Electoral Services Specialist

0118 237 9559

callum.wernham@wokingham.gov.uk

Civic Offices, Shute End, Wokingham, RG40 1BN

This page is intentionally left blank

Agenda Item IMD14

INDIVIDUAL EXECUTIVE MEMBER DECISION

REFERENCE IMD: IMD 2023/14

TITLE	Moving Traffic Orders for MTE sites Wokingham Borough Council (Various Roads, Wokingham) (Prohibition of Turning, Prescribed Route, One-Way, Prohibition of Vehicles, Bus Lane, 7.5 Tonne Weight & 6' 6" Width Restriction) Order 2023.
DECISION TO BE MADE BY	Executive Member for Active Travel, Transport and Highways - Paul Fishwick
DATE, MEETING ROOM and TIME	27 July 2023 FF12 at 1pm
WARD	Emmbrook; Norreys; Shinfield South; Wescott;
DIRECTOR / KEY OFFICER	Director, Place and Growth - Giorgio Framaliccio

PURPOSE OF REPORT (Inc Strategic Outcomes)

To report the results of the statutory consultation for the above-named Traffic Regulation Order (TRO) which revokes entirely the orders listed below and combines them into the new order and obtain the decision of the Executive Member for Active Travel, Highways & Transport.

- the Royal County of Berkshire (Wokingham) (Prohibition of Vehicles) Order 1967
- the Royal County of Berkshire (Murdoch Road, Wokingham) (Traffic Regulation) Order 1987
- the Wokingham District Council (Prohibition of Driving, No Waiting At Any Time, No Loading or Unloading, Disabled Parking and One Way Traffic) Order 2004

RECOMMENDATION

That the Executive Member for Active Travel, Highways and Transport:

- 1) Note that no objections or correspondence have been received during the statutory objection period 11th May 2023 to 8th June 2023.
- 2) Agrees to proceed with the making of the Order in accordance with the Road Traffic Regulation Act 1984 and the Local Authorities Traffic Order Procedures 1996, as set out in Appendix A to the report.

SUMMARY OF REPORT

Wokingham Borough Council applied to the Department for Transport (DfT) for a designation order to grant civil enforcement powers for the enforcement of moving traffic contraventions across the borough in February 2023. The designation order was laid before parliament on the 27th June 2023 and came into force on 22nd July 2023.

A review of the current moving traffic restrictions identified 11 sites where the Council would enforce by issuing Penalty Charge Notices (PCN) to vehicles found to be

contravening the restrictions through automatic number plate recognition (ANPR) cameras under the new powers granted in the designation order. The restriction for one of the sites did not require a traffic order, the traffic orders for the 10 remaining were consolidated and put into one traffic order for better administration and management by the Council and updated to include current best practice elements.

The traffic order was taken through formal consultation with the statutory objection period running between 11th May 2023 and 8th June 2023.

There were no objections or comments received therefore it is proposed that the TRO is made as advertised and that relevant notices are advertised in accordance with the Local Authority Traffic Order making procedures to make the order.

Background

Wokingham Borough Council applied to the Department for Transport (DfT) for a designation order to grant civil enforcement powers for the enforcement of moving traffic contraventions across the borough in February 2023. The designation order was laid before parliament on the 27th June 2023 and came into force on 22nd July 2023.

A review of the current moving traffic restrictions identified 11 sites where the signs and site conditions did not comply with current road safety standards. These restrictions were previously only enforced by the police however with the granting of the designation order and powers by the DfT, the Council is now able to enforce by issuing penalty charge notices (PCN) to vehicles found to be contravening the restrictions through automatic number plate recognition (ANPR) Cameras.

The traffic orders for the 11 sites were reviewed and it was identified that 10 of them needed to be updated to include current best practice elements. The individual traffic orders for the 10 locations were consolidated and put into one traffic order for better administration and management by the Council. These updates were advertised in a new consolidated traffic order on the 11th May 2023. The table below shows the restrictions which were advertised through the traffic order.

Site	Location	Contravention
1	Broad Street, Wokingham	Banned right turn
2	Barkham Road rail crossing	Banned right turn
3	Station Road, Wokingham	Banned right turn
4	Bolton Drive, Spencer's Wood,	Vehicles prohibited except buses, emergency vehicles and pedal cyclist
5	Gypsy Lane, Wokingham	7.5T Weight restriction
6	Murdoch Road, Wokingham	6'6" (2m) width restriction
7	Goatley Way, Wokingham	One way street
8	Milton Road, Wokingham	Vehicles prohibited except buses, emergency vehicles
9	Fullbrook Avenue and Bolton Drive junctions with Hyde End Lane, Spencer's Wood,	Buses only, Emergency Service vehicles and pedal cyles
10	Whitlock Avenue, Wokingham	Banned right turn

Response to TRO Consultation

The traffic order has now been taken through formal consultation. The statutory objection period started on 11th May 2023 and ended on 8th June 2023. There were no objections or comments received.

Recommendation & Conclusion

It is recommended that the Wokingham Borough Council (Various Roads, Wokingham) (Prohibition of Turning, Prescribed Route, One-Way, Prohibition of Vehicles, Bus Lane, 7.5 Tonne Weight & 6' 6" Width Restriction) Order 2023 be approved for signing and sealing and that relevant notices are advertised in accordance with the Local Authority Traffic Order making procedures to make the order.

FINANCIAL IMPLICATIONS OF THE RECOMMENDATION

The Council faces unprecedented financial pressures as a result of; the longer term impact of the COVID-19 crisis, Brexit, the war in Ukraine and the general economic climate of rising prices and the increasing cost of debt. It is therefore imperative that Council resources are optimised and are focused on the vulnerable and on its highest priorities.

	How much will it Cost/ (Save)	Is there sufficient funding – if not quantify the Shortfall	Revenue or Capital?
Current Financial Year (Year 1)	£7600	Yes	Revenue
Next Financial Year (Year 2)	Nil		
Following Financial Year (Year 3)	Nil		

Other financial information relevant to the Recommendation/Decision
Above costs are for the provision of new signs and lines to make the sites compliant with the TRO and ensure the restrictions can be legally enforced.

Cross-Council Implications
N/A

Public Sector Equality Duty
EQIA Initial Impact Assessment has been completed and no impact or disproportionate impact has been identified.

SUMMARY OF CONSULTATION RESPONSES	
Director – Resources and Assets	No further comments received
Monitoring Officer	No further comments received
Leader of the Council	No further comments received

For Highways use only	
Town and Parish Councils	
Wokingham Town Council	No further comments received
Shinfield Parish Council	No further comments received
Local Ward Members	
Rachel Burgess	No further comments received
Phil Cunnington	No further comments received
Marie-Louise Weighill	No further comments received
Rachel Bishop-Firth	No further comments received
Imogen Shepherd-DuBey	No further comments received
Morag Malvern	No further comments received
Catherine Glover	No further comments received
Chris Johnson	No further comments received
Jackie Rance	No further comments received
Peter Denis	No further comments received

Jane Ainslie	No further comments received
--------------	------------------------------

Reasons for considering the report in Part 2
N/A

List of Background Papers
Appendix A- Copy of Traffic Regulation Order

Contact Matt Gould	Service Place & Growth
Telephone No Tel: 0118 974 6460	Email matt.gould@wokingham.gov.uk

This page is intentionally left blank



**WOKINGHAM
BOROUGH COUNCIL**

WBC 2023 No. **

**ROAD TRAFFIC REGULATION ACT 1984
&
TRAFFIC MANAGEMENT ACT 2004**

Wokingham Borough Council

(Goatley Way, Barkham Road, Broad Street, Station Road, Whitlock Avenue, Wellington Road, Milton Road, Bolton Drive, Fullbrook Avenue, Gypsy Lane, Murdock Road, Wokingham) (Prohibition of Turning, Prescribed Route, One-Way, Prohibition of Vehicles, Bus Lane, 7.5 Tonne Weight & 6' 6" Width Restriction) Order 202*

Made on: ** ***** 202*

Coming into force on: ** ***** 202*

**Chris Easton,
Assistant Director Place & Growth,
Wokingham Borough Council,
Shute End,
Wokingham,
RG40 1WL**

CONTENTS AND ARRANGEMENT OF ARTICLES

PART I GENERAL

- 1. Citation and commencement**
- 2. Interpretation**
- 3. – 6. Application of Order**

PART II

- 7. – 8. ONE-WAY TRAFFIC**

PART III

- 9. – 10. PROHIBITION OF TURNING & PRESCRIBED ROUTES**

PART IV

- 11. – 14. PROHIBITION OF VEHICLES AT ANY TIME & BUS LANE TRAFFIC RESTRICTIONS**

PART V

- 15. – 17. WEIGHT AND WIDTH RESTRICTIONS**

PART VI

- 18. REVOCATION OF ORDERS**

SCHEDULES

- 1 ONE-WAY TRAFFIC**
- 2 PROHIBITION OF TURNING**
- 3 PROHIBITION OF VEHICLES AT ANY TIME**
- 4 BUS LANE**
- 5 7.5 TONNE WEIGHT RESTRICTION**
- 6 6'6" WIDTH RESTRICTION**

WOKINGHAM BOROUGH COUNCIL, the Council as the Local Traffic Authority in exercise of its powers under Sections 1(1),1(2), 2(1),2(2),2(3), 4(1), 4(2), 19, 65(1) and 124 and Part IV of Schedule 9 to the Road Traffic Regulation Act 1984 as amended, (hereinafter referred to as 'the Act'), Part 6 of the Traffic Management Act 2004, and all other enabling powers, and after consultation with the Chief Officer of Police in accordance with Part III of Schedule 9 to the Act hereby **MAKES** the following Order:-

PART I GENERAL

CITATION AND COMMENCEMENT

1. This Order may be cited as the **Wokingham Borough Council (Goatley Way, Barkham Road, Broad Street, Station Road, Whitlock Avenue, Wellington Road, Milton Road, Bolton Drive, Fullbrook Avenue, Gipsy Lane, Murdoch Road, Wokingham) (Prohibition of Turning, Prescribed Route, One-Way, Prohibition of Vehicles, Bus Lane, 7.5 Tonne Weight & 6' 6" Width Restriction) Order 202***

INTERPRETATION

2. In this Order, except where the context otherwise requires, the following expressions have the meanings respectively assigned to them:-

"the Council" means the Wokingham Borough Council;

"Bus" has the same meaning as in Schedule 1 of the Traffic Signs Regulations and General Directions 2016;

"Bus Lane" has the same meaning as in Schedule 1 of the Traffic Signs Regulations and General Directions 2016;

"Bus-only route" means a traffic lane that may be used only by buses (or a particular description of bus) and some other class or classes of vehicular traffic as provided for in this Order and specified on a corresponding Plan;

"Emergency Services Vehicle" means a vehicle operated by the police, fire & rescue service or ambulance service;

"Goods Vehicle" has the same meaning as in the Traffic Signs Regulations and General Directions 2016;

"Maximum Gross Weight" has the same meaning as in the Traffic Signs and Regulations and General Directions 2016 and the maximum permissible laden weight of a motor vehicle is the gross weight indicated on the plate displayed on that motor vehicle as required by Regulation 70 and Schedule 10, Motor Vehicle (Construction and Use) Regulations 1986 (Ministry Plate) or in the event such a plate is not displayed the gross weight for Great Britain, displayed on the vehicle as required by Regulation 66 and Schedule 8, Motor Vehicle (Construction and Use) Regulations 1986.

"Pedal Cycle" has the same meaning as in Schedule 1 of the Traffic Signs Regulations and General Directions 2016; or that of an electrically assisted pedal cycle producing no more than 250 watts of power (continuously rated) and which cuts out at 15.5mph.

"Plan" means the plan or plans relating to those items contained in Schedules 1 to 5 which are attached and incorporated into this Order and shall be construed accordingly;

“Road” means the full width – including any footway or verge – of any length of highway or of any other road to which the public has access, and includes bridges over which a road passes;

“Vehicle” means a mechanically propelled or pedal powered form of transportation intended or adapted for use on the road.

3. Except where otherwise stated, any reference in this Order to a numbered Article or Schedule shall, unless the context otherwise requires, be construed as a reference to the Article or Schedule bearing that number in this Order and any reference to a Plan is a reference to a Plan incorporated into this Order.
4. The prohibitions and restrictions imposed by this Order shall be in addition to and not in derogation of any restriction, prohibition or requirement imposed by any Regulations or Orders made or having effect as if made under the Act of 1984, or by or under any other enactment.
5. Save where the contrary is indicated, any reference in this Order to: (a) this Order or another Order shall be construed as such a reference to this Order or, as the case may be, such other Order, as the same may have been or may from time to time be amended, varied or supplemented; (b) a Statute or Regulation shall be construed as reference to such Statute or Regulations as the same may have been, or may from time to time be amended or re-enacted.
6. Nothing in Articles 8, 9, 10 or 17 shall apply to any vehicle on an occasion when it is being used for Fire Brigade, Ambulance or Police purposes (in the event of an emergency), if the observance of that provision would be likely to hinder the use of that vehicle for the purpose for which it is being used on that occasion, or a vehicle in the service of the local authority in the course of road cleansing or gully emptying.
7. The Interpretation Act 1978 shall apply to the interpretation of this Order as it applies to the interpretation of an Act of Parliament and as if for the purposes of section 21 of that Act this Order were an Act of Parliament and the Orders revoked by this Order were Acts of Parliament thereby repealed.

PART II

ONE-WAY TRAFFIC

8. Save as provided in Article 6, no person shall cause or permit any vehicle to proceed in the length of road specified in column 1 of Schedule 1 to this Order other than in the direction specified in column 2 of that Schedule and specified on the corresponding plan for the said road.

PART III

PROHIBITION OF TURNING & PRESCRIBED ROUTES

PROHIBITION OF TURNING

9. No person shall except upon the direction of or with the permission of a police constable in uniform, drive or cause or permit to be driven any vehicle proceeding in any of the lengths of road specified in column 1 of Schedule 2 to this Order to make a turn as specified on to the road specified in Column 2 of the said Schedule and specified on the corresponding plan for the said road.

PRESCRIBED ROUTE

10. Save as provided in Article 6, every person causing any vehicle to proceed in a northwards direction in Wellington Road shall, on reaching the junction with Barkham Road / Station Road, Wokingham cause that vehicle to proceed in an Ahead Only direction onto Station Approach as specified on the corresponding plan for the said road.

PART IV PROHIBITION OF VEHICLES & BUS LANE TRAFFIC RESTRICTIONS

PROHIBITION OF VEHICLES

11. Save as provided in Article 13, no person shall cause a vehicle to enter the length of road specified in column 1 of Schedule 3 to this Order and specified on the corresponding plan for the said road, unless that vehicle is proceeding in the direction specified in column 3 of that item and is of a type specified in column 4 of that item.

BUS LANE TRAFFIC RESTRICTIONS

12. No person shall use a vehicle or cause or permit any vehicle to be in any of the lengths of bus lane specified in column 1 of Schedule 4 to this Order and specified on the corresponding plan for the said road, unless that vehicle is proceeding in the direction specified in column 3 of that item and is of a type specified in column 4 of that item.
13. Nothing in Articles 11 or 12 shall prevent any person causing or permitting any vehicle to be in the length of road specified in Schedule 3 to this Order or to be in any of the lengths of bus lane specified in Schedule 4 to this Order and in the direction specified, insofar as it is absolutely necessary, to enable the vehicle to be used for any of the purposes set out hereunder, or to wait in the bus lane for so long as may be necessary for any of those purposes:-
 - (a) the removal of any obstruction or vehicle to effect emergency repairs to a vehicle in the bus lane so as to relieve any obstruction.
 - (b) Police, Fire Brigade, Ambulance or Civil Defence purposes;
 - (c) the service of any local authority or water authority in pursuance of statutory powers or duties; or in connection with the supply of gas, electricity or oil, or any telecommunications system as defined in the Telecommunications Act 1984.
 - (d) to be used in connection with the maintenance, improvement or reconstruction of any length of road, or the laying, erection, alteration or repair in or near any of the lengths of road of any sewer or main, pipe or apparatus for the supply of gas, water, electricity, oil or telegraph line in the length of road or bus lane; or
 - (e) the placing, maintenance or removal of any traffic sign.
14. Nothing in Article 12 shall prevent any person causing or permitting any vehicle to be in a bus lane if the vehicle enters the bus lane in order to prevent an accident and the vehicle then leaves the bus lane as soon as it is practicable.

**PART V
WEIGHT AND WIDTH RESTRICTIONS**

7.5 TONNE WEIGHT RESTRICTION

15. Save as provided in Article 16 of this Order, no person shall, except upon the direction or with the permission of a Police Constable in uniform, cause or permit any heavy commercial vehicle in excess of 7.5 tonnes maximum gross weight to proceed along the length of road specified in Schedule 5 to this Order and specified on the corresponding plan for the said road.
16. Nothing in Article 15 of this Order shall make it unlawful for any person to cause or permit a heavy commercial vehicle to proceed along the length of road specified in the Schedule 5 to this Order (hereinafter referred to as "the road") if the said vehicle is being used:-
- (a) for or in connection with the conveyance of persons, goods or merchandise to or from any premises situated on or adjacent to the length of road;
 - (b) for such purpose in any other road, to be used in connection with any of the following operations, namely:-
 - (i) building, industrial or demolition operations;
 - (ii) the removal of any obstruction to traffic;
 - (iii) to be used in connection with the maintenance, improvement or reconstruction of any length of road, or the placing, maintenance or removal of any traffic sign;
 - (iv) the laying, erection, alteration or repair in or near any of the lengths of road of any sewer or main, pipe or apparatus for the supply of gas, water, electricity, oil or telegraph line or in connection with the supply of gas, electricity or oil, or any telecommunications system as defined in the Telecommunications Act 1984;
 - (c) the service of any local authority or water authority in pursuance of statutory powers or duties;
 - (d) the vehicle of a universal service provider (as defined in Section 4(3) and (4) of the Postal Services Act 2000) to be used for the purposes of delivering and/or collecting mail; or
 - (e) Police, Fire Brigade, Ambulance or Civil Defence purposes; or
 - (f) a vehicle to wait as long as it may be necessary to enable it to be used in the provision of a local service within the meaning of the Transport Act 1985;

6'6" (2.0M) WIDTH RESTRICTION

17. Save as provided in Article 6 of this Order, no person shall, except upon the direction or with the permission of a Police Constable in uniform, cause or permit any vehicle the width of which exceeds six feet six inches (6'6") (2.0m) to proceed in the length of road specified in Schedule 6.

**PART VI
REVOCATION**

ORDERS OR PARTS OF ORDERS TO BE REVOKED

18. The following Orders or parts of Orders are hereby revoked:-
- (a) Royal County of Berkshire (Wokingham) (Prohibition of Vehicles) Order 1967 in its entirety
 - (b) Royal County of Berkshire (Murdoch Road, Wokingham) (Traffic Regulation) Order 1987 in its entirety.
 - (c) The Wokingham District Council (Prohibition of Driving, No Waiting At Any Time, No Loading or Unloading, Disabled Parking and One Way Traffic) Order 2004 in its entirety.

**SCHEDULE 1
ONE-WAY TRAFFIC**

Roads in the Borough of Wokingham

Column 1	Column 2
1. Goatley Way	From its junction with Peach Street, in a south-eastwards and south-westwards direction for its entire length.

**SCHEDULE 2
PROHIBITION OF TURNING**

Roads in the Borough of Wokingham

Column 1	Column 2
1. Barkham Road	No Right Turn on to Oxford Road
2. Broad Street	No Right Turn on to Rose Street
3. Station Road	No Right Turn on to Station Approach
4. Whitlock Avenue	No Right Turn on to A329 London Road

**SCHEDULE 3
PROHIBITION OF VEHICLES AT ANY TIME**

Roads in the Borough of Wokingham

Column 1	Column 2	Column 3	Column 4
1. Milton Road	From a point approximately 2 metres south of the boundary between Nos.4 / 2 Milton Road, southwards for a distance of approximately 4.8 metres.	Southbound	Bus or Emergency Services Vehicle
1. Bolton Drive	From a point approximately 75 metres southwest of the extended west kerbline of Martyn Crescent, south-westwards for a distance of approximately 283 metres.	Eastbound and Westbound	Bus, Emergency Services Vehicle or Pedal Cycle

**SCHEDULE 4
BUS LANE**

Roads in the Borough of Wokingham

Column 1	Column 2	Column 3	Column 4
1. Fullbrook Avenue Bolton Drive	From a point approximately 45 metres northeast of a point opposite of the extended east kerbline of Bays Crescent eastwards for a distance of approximately 14 metres.	Eastbound	Bus, Emergency Services Vehicle or Pedal Cycle
2. Fullbrook Avenue Bolton Drive	From a point approximately 59 metres northeast of the extended east kerbline of Bays Crescent, westwards for a distance of approximately 19 metres.	Westbound	Bus, Emergency Services Vehicle or Pedal Cycle

**SCHEDULE 5
7.5 TONNE WEIGHT RESTRICTION**

Roads in the Borough of Wokingham

Item No.	Length of Road
1. Gipsy Lane	From its junction with Langborough Road, for its entire length.

**SCHEDULE 6
6'6" (2.0M) WIDTH RESTRICTION**

Roads in the Borough of Wokingham

Item No.	Length of Road
1. Murdoch Road	From a point approximately 8 metres west of its junction with South Drive / Crescent Road, westwards for a distance of approximately 23 metres.

THE COMMON SEAL of the)
WOKINGHAM BOROUGH COUNCIL)
was hereunto affixed on)
the **** * 202*)
in the presence of:-)

Authorised Signatory/ Solicitor

ORDER MAPS
GOATLEY WAY-ONE WAY TRAFFIC

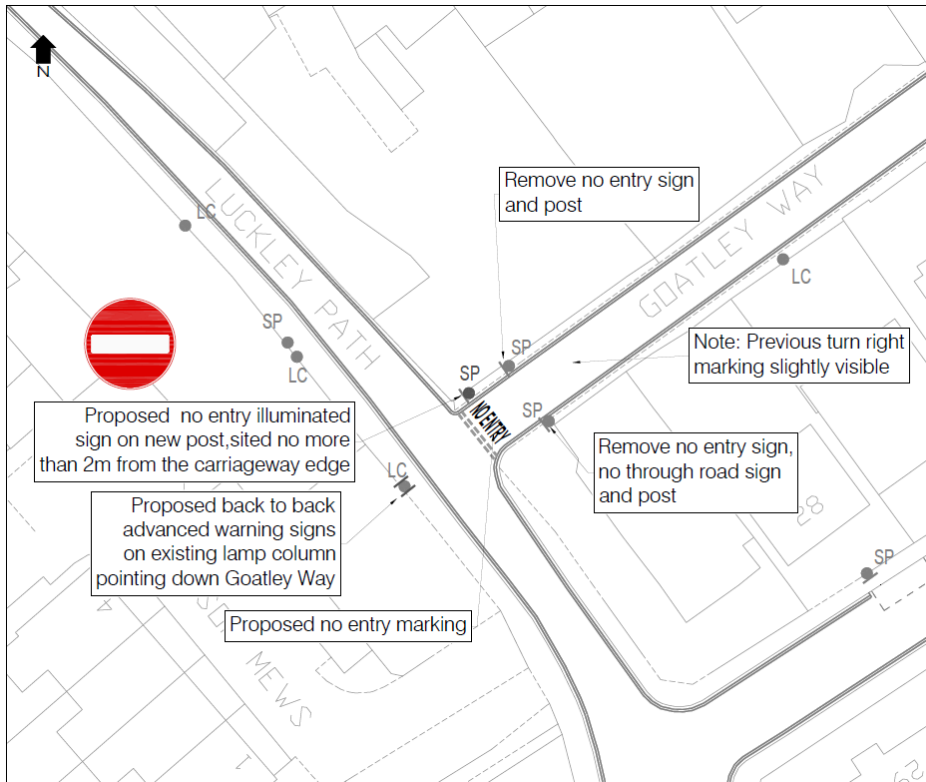

BARKHAM ROAD, STATION ROAD AND WELLINGTON ROAD-PESCRIBED ROUTE
BANNED RIGHT TURNS

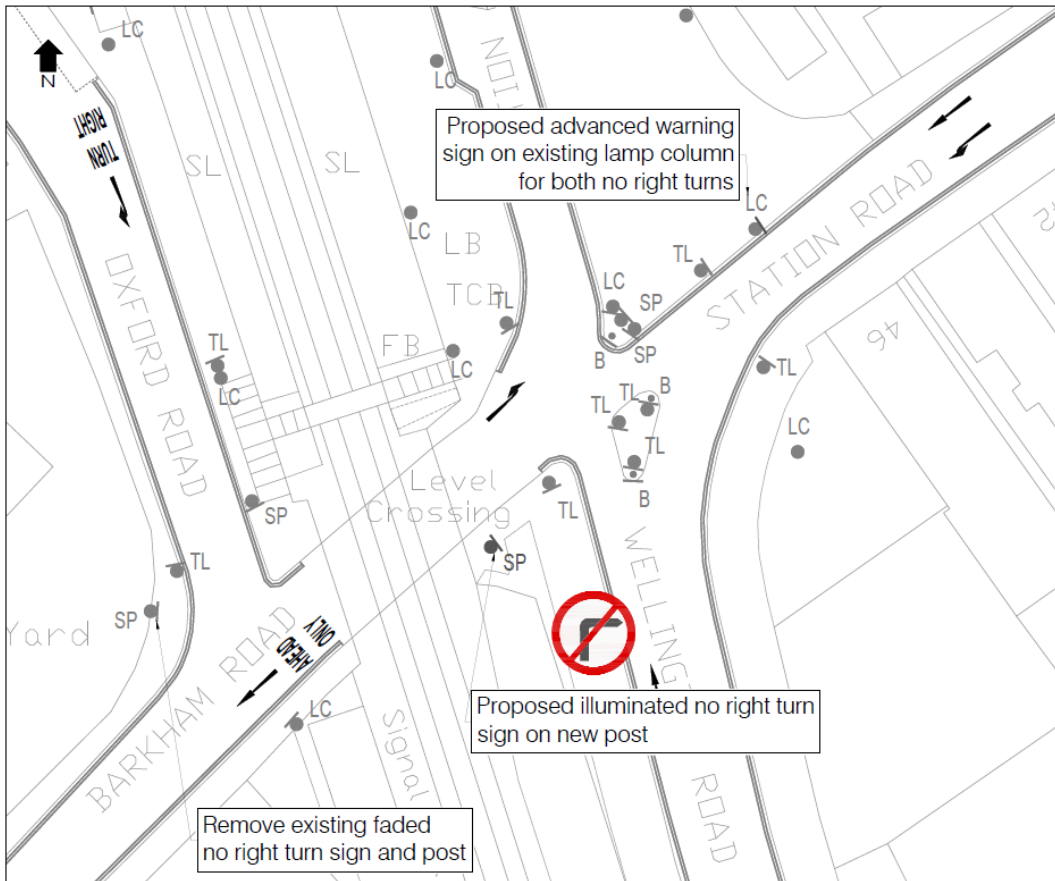

BROAD STREET-BANNED RIGHT TURN

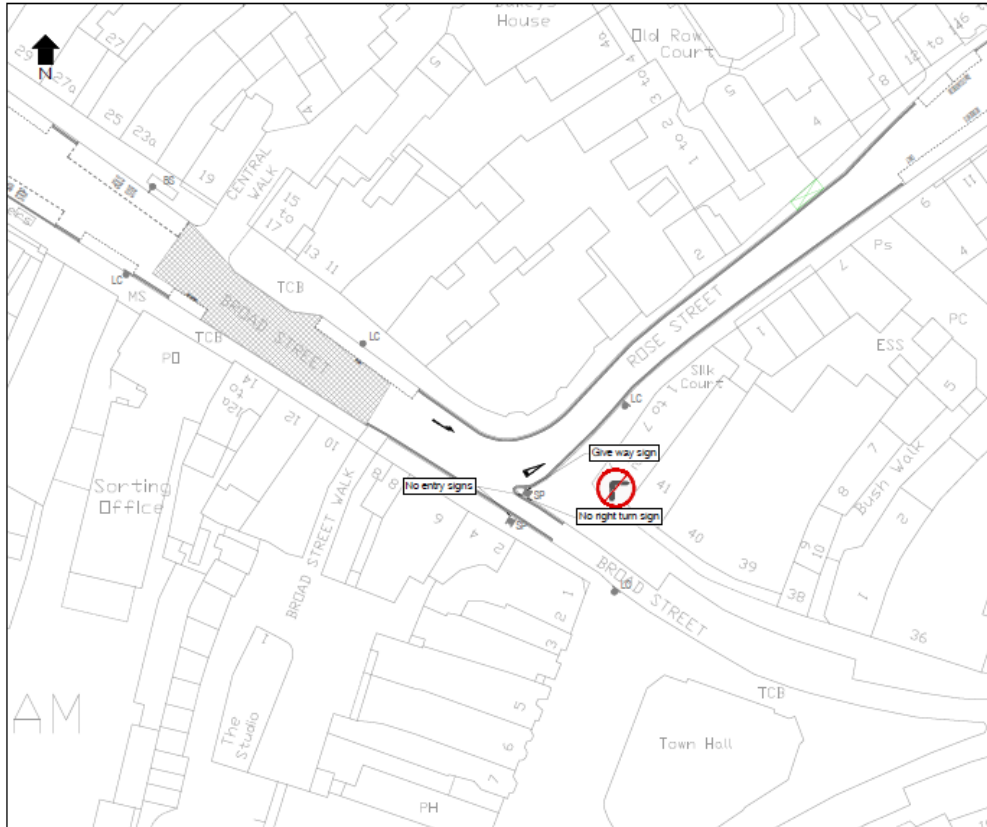

WHITLOCK AVENUE-BANNED RIGHT TURN

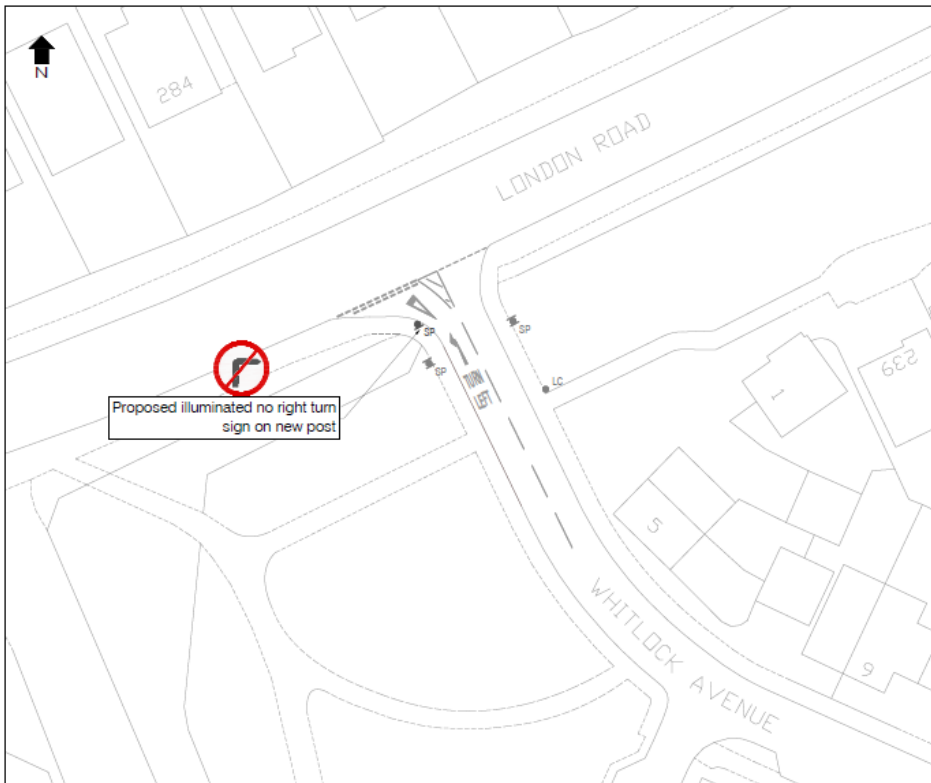

GIPSY LANE-WEIGHT LIMIT

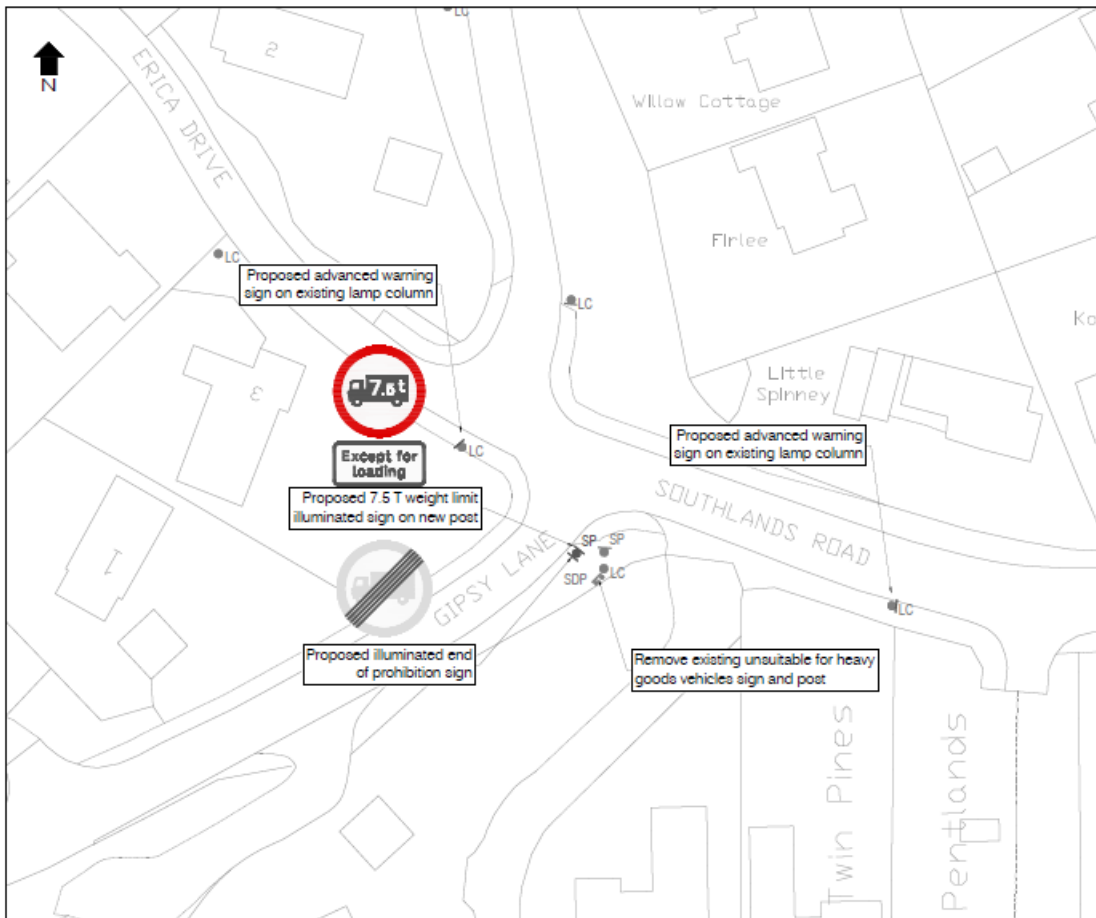
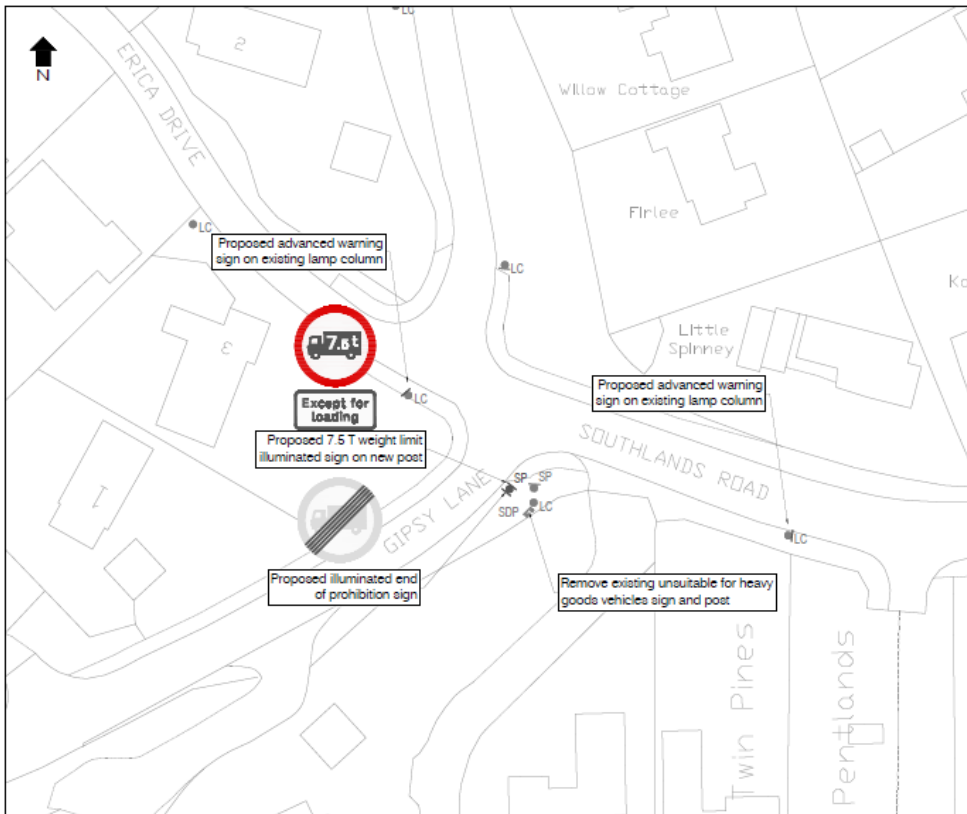

MURDOCH ROAD- WIDTH LIMIT

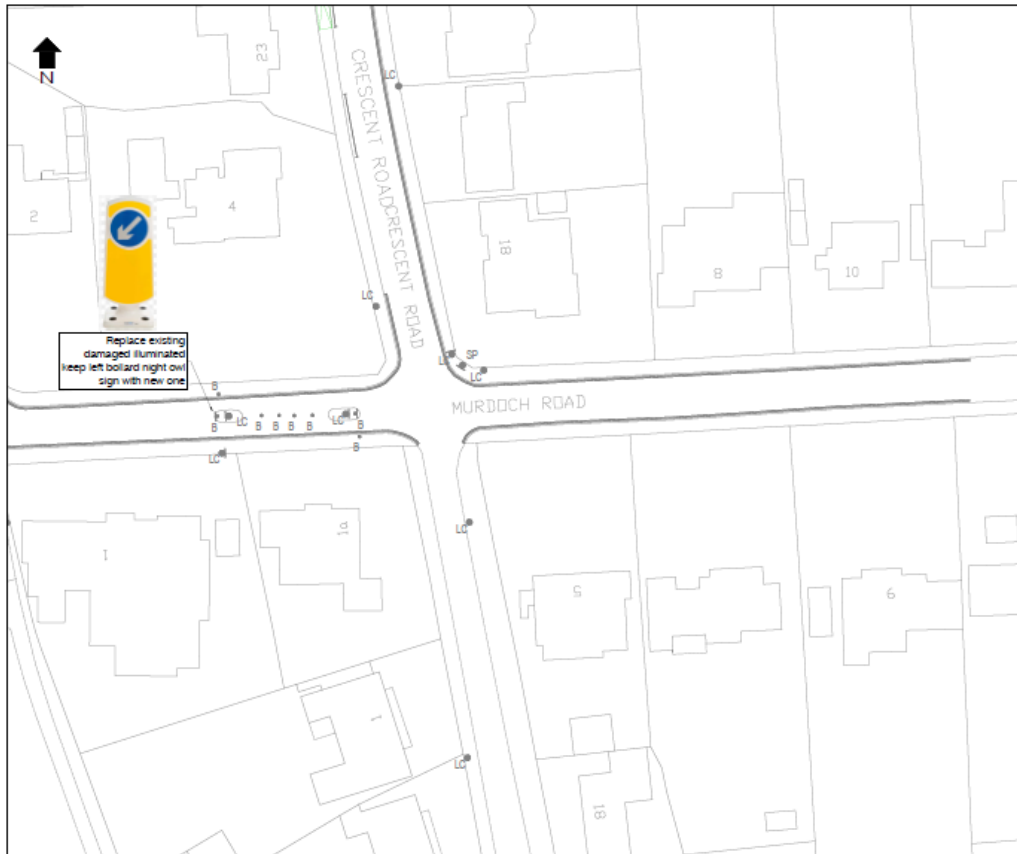

MILTON ROAD-PROHIBITION OF VEHICLES

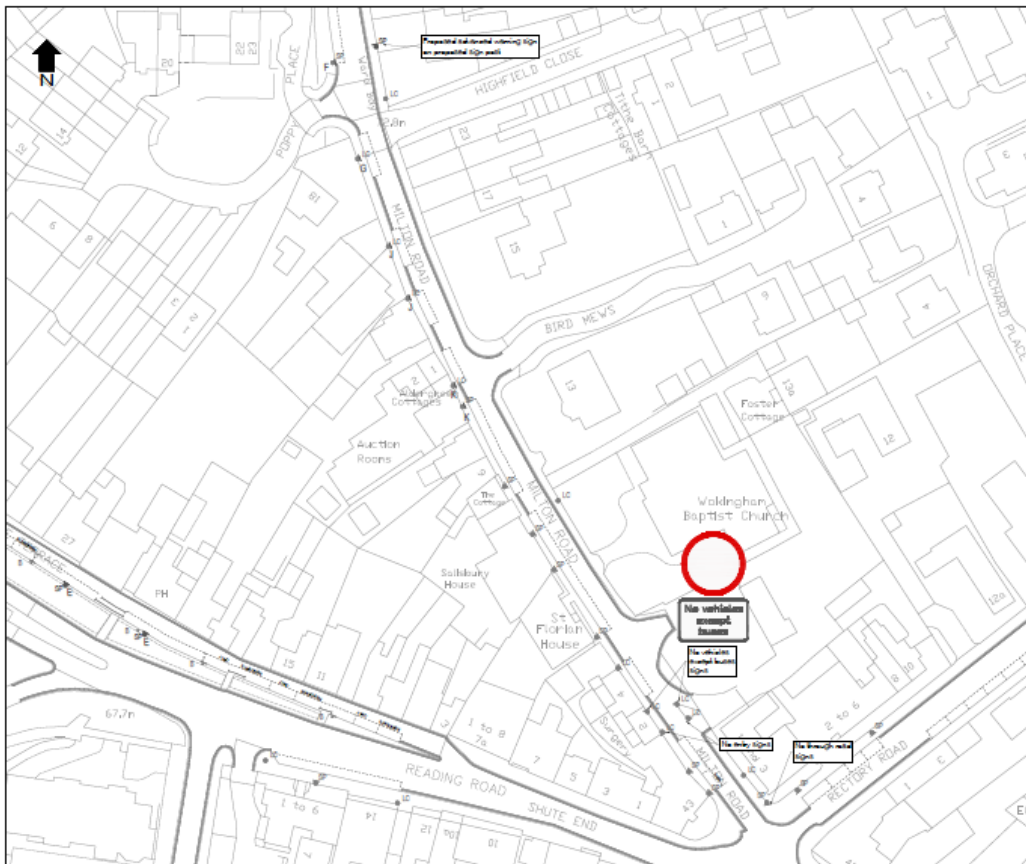

FULLBROOK AVENUE AND BOLTON DRIVE-BUS LANE AND NO ENTRY

